

RCS Stock Chiller SC02 & SC03 Maintenance Instructions: Replacing O-rings

Before performing any maintenance operation with the Stock Chiller, it is IMPORTANT and NECESSARY to disconnect the power supply to the unit by unplugging the electrical cord from the outlet. Do not attempt to turn on the unit while the motor covers are unsecured. There are high speed rotating machinery hazards and electrical hazards when the motor cover is not secured and the unit is plugged in.

An instructional video detailing all the steps in this maintenance guide is also available for viewing at: http://youtu.be/ZC_zmP6Lr1Q

Tools needed:

- 9 replacement O-rings (SC02) or 7 replacement O-rings (SC03)
- Phillips head screw driver or variable speed driver with a Phillips head bit
- 5/32" or 4mm hex key
- 12" (300mm) or longer straightedge

If you need any assistance call our service and support department at 1-877-C-COOLER (1-877-226-6537) or email info@stockchiller.com.

Directions:

1. Remove the back/left motor cover by removing the screws holding it in place (a). Save all the hardware. There are three quick disconnect terminals that need to be pulled off the power entry module before the cover can be fully detached (b). It is not recommended to detach these terminals if there is sufficient space to keep the cover near the unit while performing maintenance.

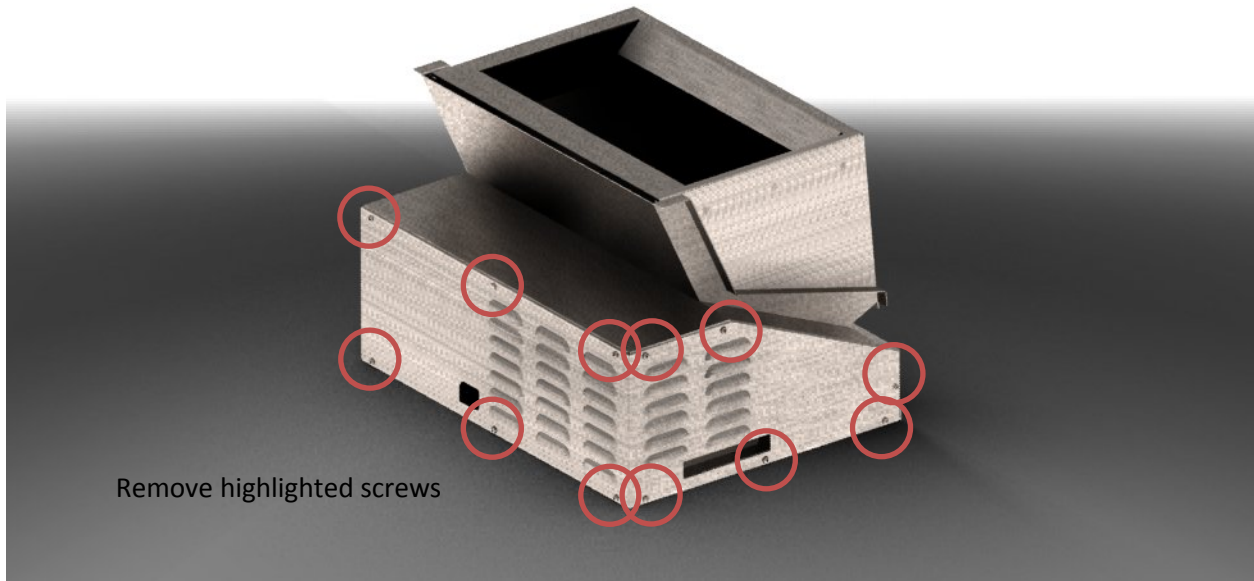

(a)

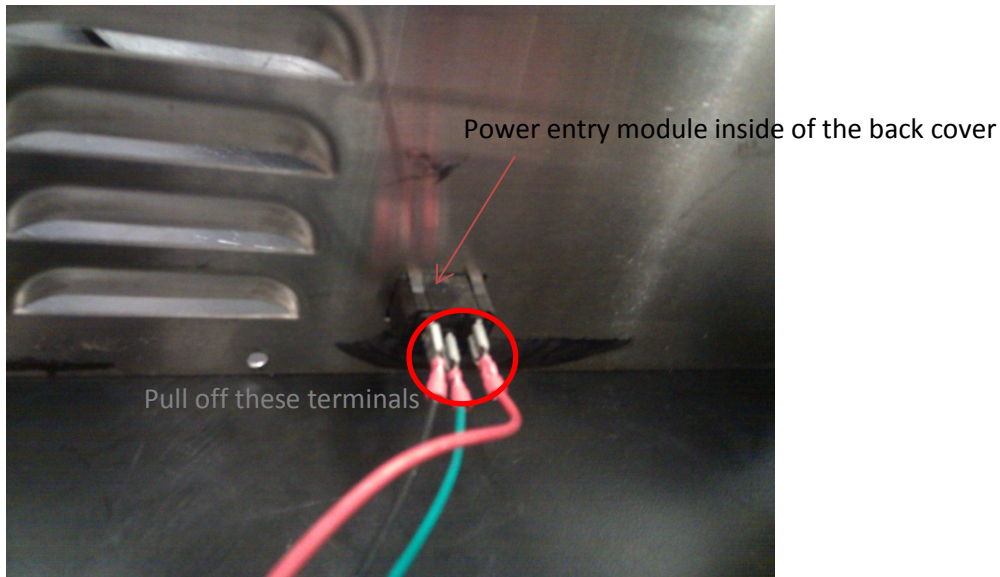

(b)

If you need any assistance call our service and support department at 1-877-C-COOLER (1-877-226-6537) or email info@stockchiller.com.

2. After removing the motor cover, remove both pulleys and the belt. The pulleys are secured with a set screw that can be loosened with a 5/32" or 4mm hex key. The belt and pulley can be rotated to allow for access to the set screw. Loosen the pulleys first and then slide them off their shafts with the belt simultaneously.

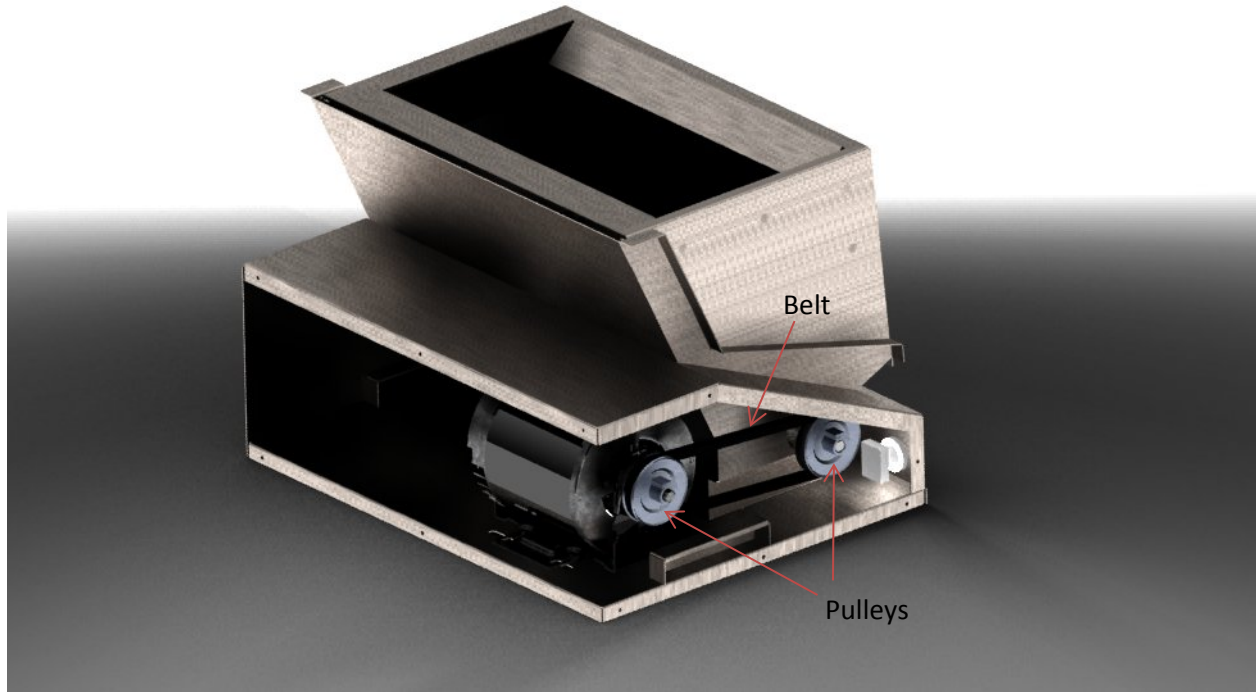

3. Open the top lid of the unit. Remove the 4 screws at the left side of the chilling bay near the roller.



If you need any assistance call our service and support department at 1-877-C-COOLER (1-877-226-6537) or email info@stockchiller.com.

4. Pull out the bearing block assembly from the left side of the unit.

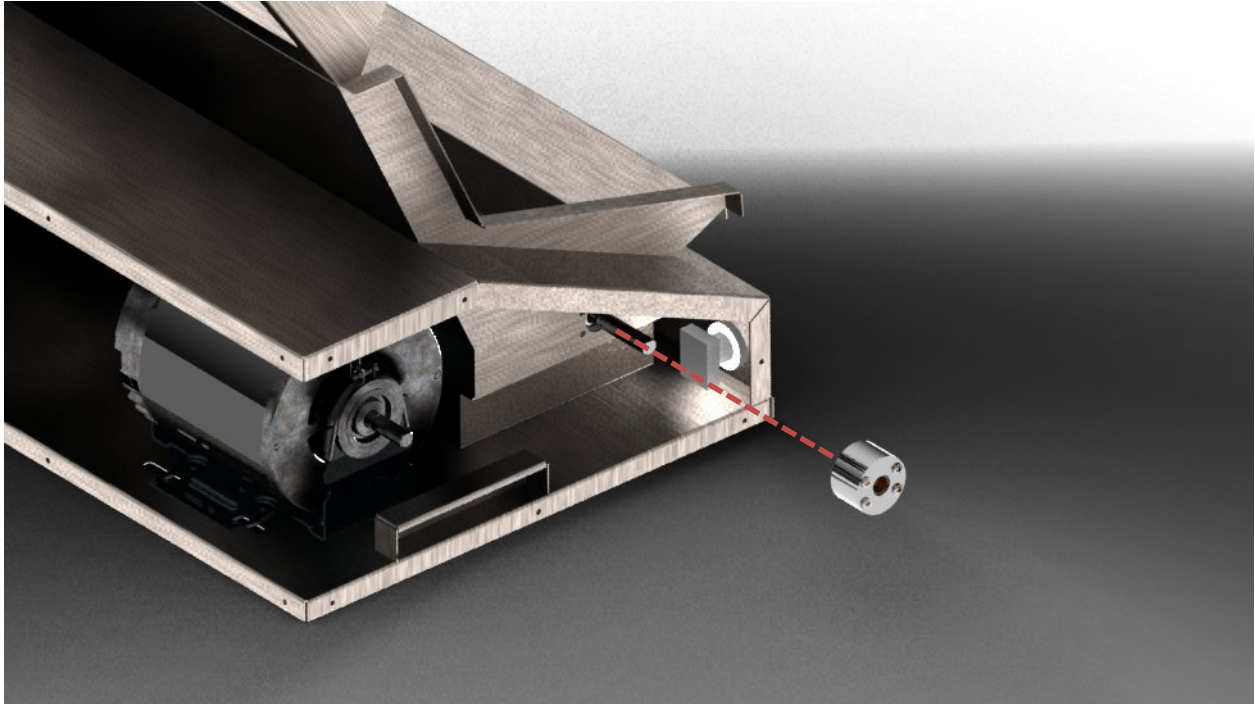

5. Remove the roller bar. First, pull the bar to the left until the right side of the bar is freed, then pull the bar up on the right side and then pull the bar from the hole on the left.



If you need any assistance call our service and support department at 1-877-C-COOLER (1-877-226-6537) or email info@stockchiller.com.

6. Remove or clip-off the existing O-rings. It is highly recommended to change all O-rings at the same time.

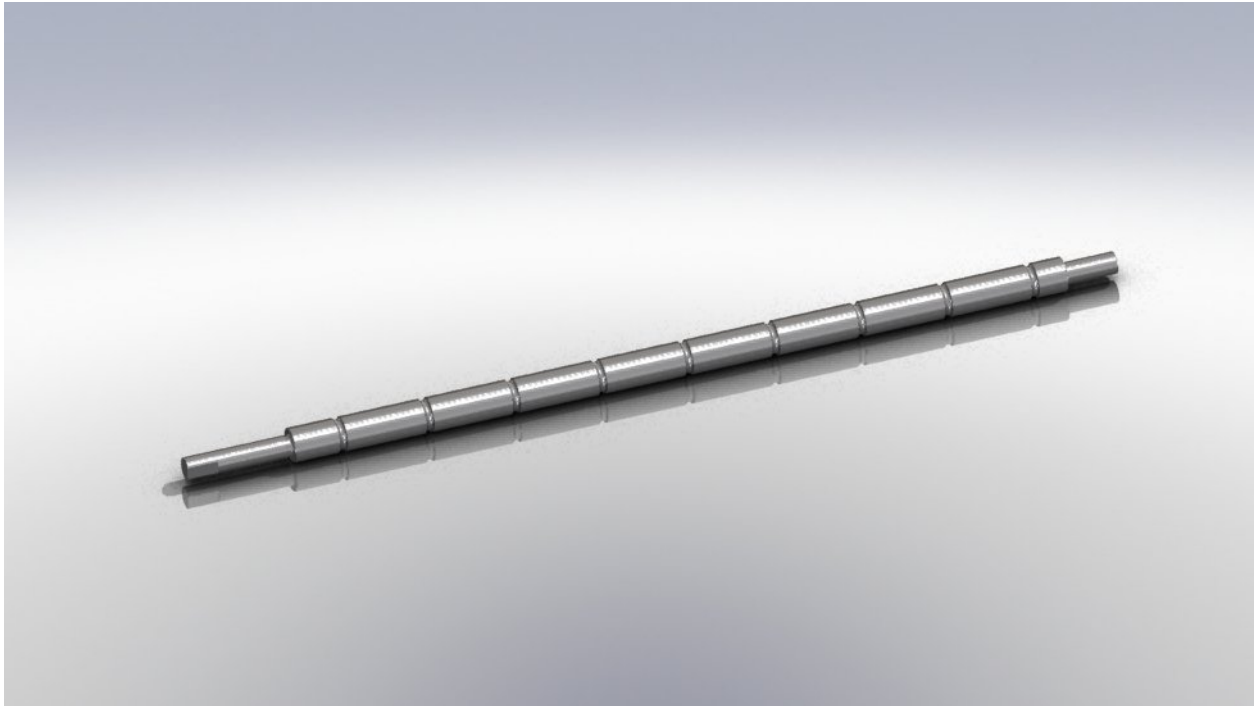

7. Replace the O-rings by sliding the O-rings one at a time over the roller from the ends to the center. It is essential to keep the O-rings from inverting during this process. It is highly recommended that the O-rings not be slid over other O-rings to prevent over-stretching them. Make sure the O-ring sits in the groove.



If you need any assistance call our service and support department at 1-877-C-COOLER (1-877-226-6537) or email info@stockchiller.com.

8. Image below shows completed O-ring replacement. Replace the roller bar into the unit. Angle the left side through the hole on the left side of the unit, and then position the right side to slide into the roller holder on the right side of the chilling bay.

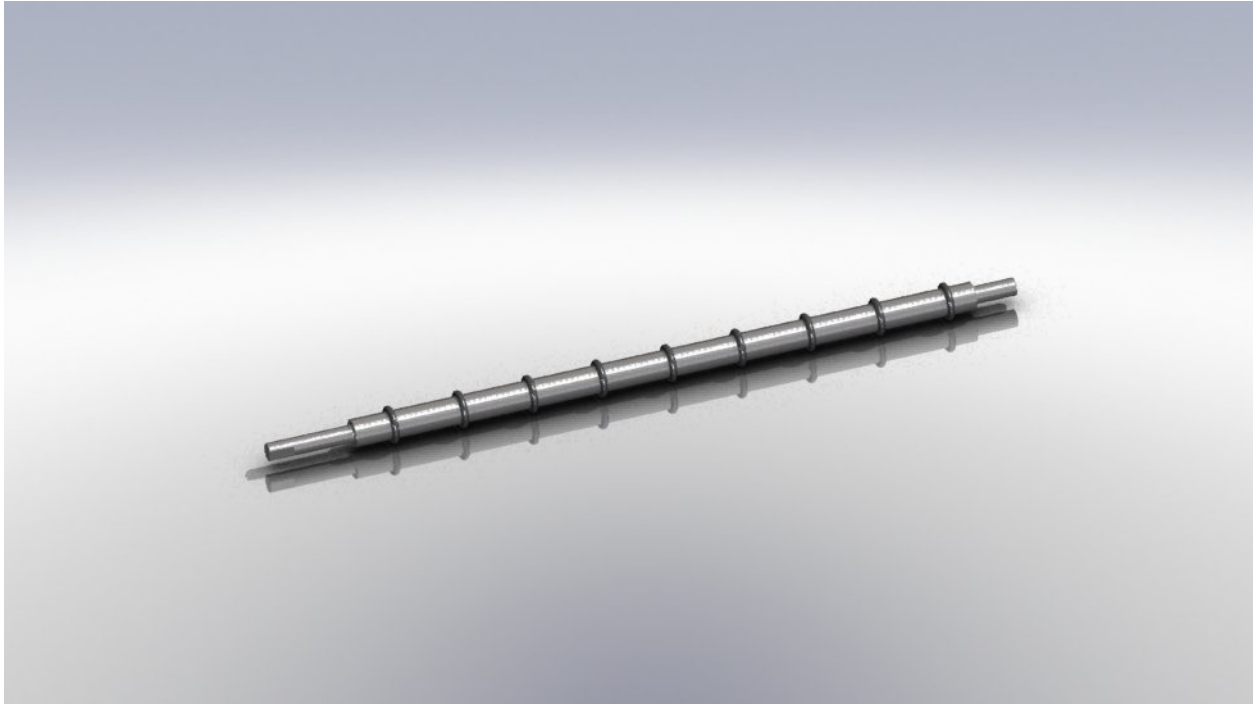

9. Replace the bearing block on the left side of the unit by sliding it along the roller. Line up the screw holes with the through holes on the left side of the chilling bay. Replace the 4 screws that were removed earlier. The split lock washers should be between the underside of the screw heads and the flat washers. Close the lid on the chilling bay.

10. Replace the belt and pulleys. Use a straightedge against the sides of the pulleys to keep them aligned relative to the belt. The set screws should be secured to the flat section of the roller and the motor shaft.

If you need any assistance call our service and support department at 1-877-C-COOLER (1-877-226-6537) or email info@stockchiller.com.

11. If disconnected, reattach the electrical wires to the power entry module. The green wire (GROUND) connects to the center terminal and the other two wires can be connected to either of the remaining terminals.

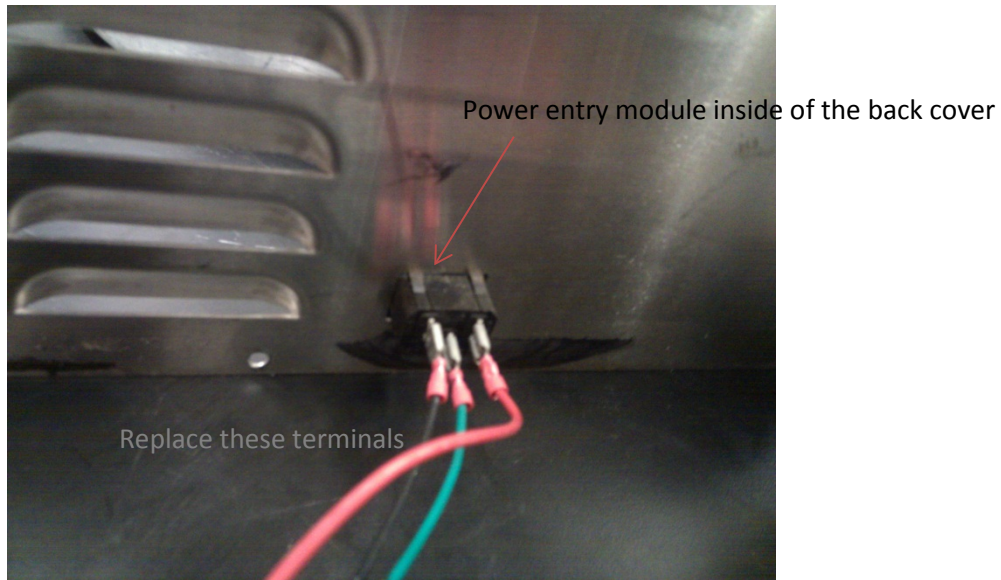

12. Replace the cover and secure the screws. The split lock washers should be between the underside of the screw head and the flat washers.

13. Reconnect the power cord and test the unit before placing back into active service.

If you need any assistance call our service and support department at 1-877-C-COOLER (1-877-226-6537) or email info@stockchiller.com.